

# PRODUCT CODE: CA105

PRODUCT DESCRIPTION: BLOCK GRAB  
PRIMARY FUNCTION: TO LIFT PALLETISED BLOCKS AND BRICKS

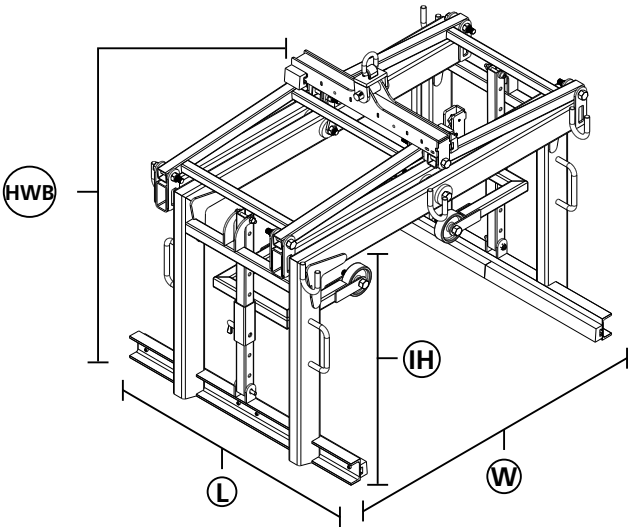

Designed and manufactured to lift palletised blocks and bricks. The CA105AC Scissor Grab is also suitable for handling all types of concrete products such as slabs, steel strapped bricks, blocks, kerb stones and paving blocks.

The CA105AC has an automatic catch mechanism that enables a single operator to stack or unstack secure loads.

The CA105AC has galvanised top arms and load levelling arms to increase durability, the new design is now much stronger and has an increased WLL of 2000kg.

The CA105AC can be used with the FA105 Fork Mounting Attachment.

IH mm	H mm	HWB mm	D mm	W mm	WLL Kg
800	770	1260	1200	1410	2500
1000	975	1740	1200	1580	1800

## BASIC SAFETY

**IMPORTANT:** Read these instructions before using this equipment. If there is anything you do not understand or if you have any concerns **DO NOT** use this equipment. Contact your supervisor or Conquip for advice.

You should check that you have considered all the safety requirements for the task you are doing and that this equipment is suitable.

You must protect bystanders and the general public by preventing access to the working area.

**DO NOT** use this equipment if you are tired, unwell or under the influence of alcohol or drugs. If you are taking any medicine or undergoing treatment you should inform your supervisor.

You must be competent, alert and medically fit when using this equipment. If you have a medical condition, a mental or physical disability, you must seek advice from a medical professional before using this equipment.

A **RISK ASSESSMENT** must be completed by a competent person before using this equipment to control risks, produce a safe system of work and ensure safety for you, your colleagues and others.

Your risk assessment will determine the correct Personal Protective Equipment (PPE) for the task you are doing. You **MUST** use it.

Conquip recommends that you should wear:

- Suitable Clothing
- Gloves
- Hard Hat
- Protective Footwear (steel toecaps)



**DO NOT** wear loose clothing or jewellery and tie back long hair to avoid becoming tangled or trapped in this equipment.

You **MUST** make everyone in the work area aware of what you are doing. **NO SURPRISES.**

This equipment should be operated, stored and transported upright.

Make sure you know how to use this equipment and understand all aspects of its operation in case of emergency.

This equipment weighs more than 25kg. **DO NOT** lift or manhandle without machine assistance.

This equipment must be inspected by a competent person before use and then regularly, as determined by your risk assessment or working practice. If you have any concerns about condition or suitability **DO NOT USE.**

**DO NOT** operate this equipment near overhead power lines.

**TAKE CARE** in confined spaces, near ceilings or similar hazards.

This equipment was designed for vertical lifting. **DO NOT** drag, tilt or swing.

Before lifting, check that the load is balanced and stable. Keep all personnel clear of raised loads and far enough away to allow for movement caused by a shifting load.

**CRUSH RISK.** Keep hands and feet clear of this equipment at all times to avoid injury.

**DO NOT LEAVE UNATTENDED.** The operator must remain in control of this equipment whenever it is loaded.

Before lowering a load make sure that the landing zone is clear

and capable of accepting the size and weight of the load.

Total weight of the equipment plus the load must not exceed 50% of the forklifts WLL.

Manoeuvre loaded or raised equipment carefully. Travel and turn slowly to avoid unit becoming unstable.

Please distribute the load in this equipment evenly.

**DO NOT** exceed the maximum working load limit shown on the serial plate.

Before lifting, forks must be fully engaged and the security chain, or heel pins **MUST BE** correctly fitted.

**HEAD, HANDS & FEET** must be kept clear.

Trucks used for lifting and moving this equipment must be capable of lifting the equipment and its load.

**DO NOT** exceed **WORKING LOAD LIMIT.**

Before operating this equipment make sure that the working area is clear of hazards, obstructions and personnel.

Check that the equipment has the correct load rating and dimensions for the intended load.

Before operating this equipment, check that you have enough space for you to work safely. Allow space for the equipment to move if the load shifts.

## SET UP

Attach the lifting equipment's hook to grab the lifting eye. Always ensure that the hook's gate is correctly closed.

Now position the height of the contact wheels so that the distance from the grab jaws to the wheels is equal to the loads height.

Place the grab on the ground making sure that its jaws are fully open. Unlock the contact wheel, lower as required then re-lock.

This adjustment must be carried out to equal setting on both sets of wheels.

The grab is now ready to use.

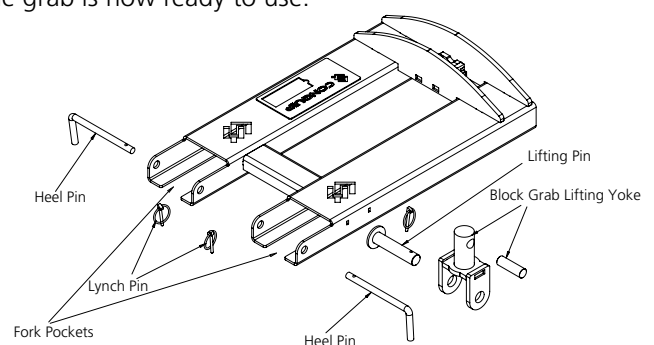
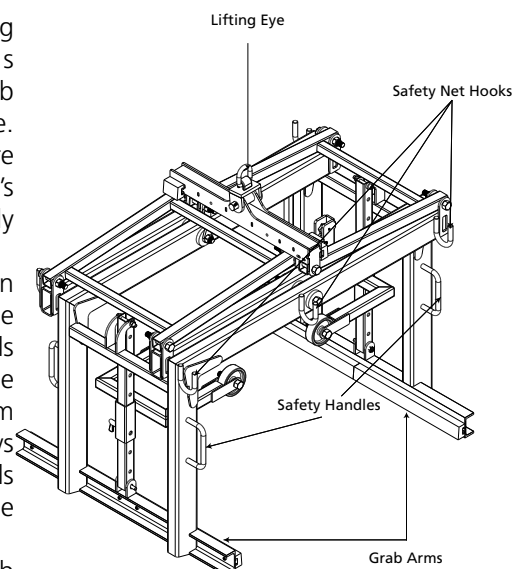

## USING THE FORK MOUNTING ATTACHMENT

This device enables you to use the grab whilst attached to a forklift or telescopic fork lift.

Firstly, fit the attachment to the forks. Set the forks to the

# POWERED BY KNOWLEDGE

correct width then drive the forks into the two fork tubes. Secure the attachment to the forklift using the chain, make sure that the chain is correctly locked in position. Remove the attachment's mounting plate lock pin ready for the grab. Next, remove the lifting eye assembly from the grab. Remove the lynch pin then extract the lock pin. Place all parts somewhere safe, where they can be easily found when next required. Using the fork lift and taking great care not to allow your hands to become trapped, lower the attachment over the grab. Align the mounting plate with the grab's lifting eye mount. Once aligned, inset the mounting plate lock pin fully and replace the lynch pin.

### **WARNING - LOAD DAMAGE**

This type of lifting equipment relies upon a 'crushing' force to grip the load prior to and during the lift. There will always be the possibility that the load (especially of soft materials) may break up and become unstable during the lift. You should therefore inspect each load prior to lifting, to ensure its suitability. DO NOT attempt to adjust or manhandle a load whilst it is in a raised position.

### **LIFTING AND LOWERING THE LOAD**

When lifting stacked loads such as building blocks, the pack MUST be secured together with banding. If not banded, the blocks may separate during the lift. The grab arms should not be in contact with the ground. However, when lifting blocks, the grab arm should be no higher than 1/3 up the block. Always try to lift the blocks end on rather than the sides. The loads length must not be greater than the grab arms. DO NOT drag the load; this equipment is for lifting the load clear off the ground. Raise the grab and position over the load, checking that it is

centrally aligned before lowering. Lower the grab until the automatic locking mechanism closes onto the load. You can now carefully raise the load just off the ground and check for balance and security. It is advisable to fit a safety net under the loaded grab, securing it to the tested safety net hooks, NOT to the safety handles. ONLY use a tested and certified net as supplied by Conquip Engineering Group. Remember; DO NOT allow hands or feet to come between, or below the grab and the load. If all is OK, proceed to move the load to its required position. Move slowly and carefully; do not jolt the load. When in position, lower the load until in contact with the ground. The grab jaws will automatically release and allow you to raise it clear of the load. You can now proceed to the next load. Caution; an unloaded grab will alter between grip and release each time it receives a jolt. This may cause the jaws to be out of sync when you next attempt to 'grab a load'.

### **FINALLY**

With the grab free of any load, lower it to the ground. Release the lifting equipments hook and drive it clear. If using the fork lift attachment, reverse the fitting instruction to return the grab to 'crane' use. All that remains is to give the grab a thorough clean ready for return.

### **EQUIPMENT MAINTENANCE AND CLEANING**

When not being used, store the unit in a clean condition and in a safe place where it will be protected from thieves and unauthorised users.

**NOTE: FAILURE TO CLEAN THIS EQUIPMENT THOROUGHLY MAY RESULT IN A CHARGE.**

### **WARRANTY**

Conquip Engineering Group products are covered by a 12 month warranty. Conquip Engineering Group undertakes to replace or repair, free of charge, any defect which the Company considers to be due to faulty workmanship or material within 12 months of the sale date, except for:

Defects arising from neglect, misuse or unauthorised modifications.

Damage caused by abuse, misuse, dropping or other similar damage caused by or as a result of failure to follow transportation, storage, loading, cleaning or operation instructions.

Alterations, additions or repairs carried out by persons other than Conquip Engineering Group or their recognised distributors. Transportation or shipment costs to and from Conquip Engineering Group or their recognised agents, for repair or assessment against a warranty claim, on any product or component.

Materials and/or labour costs to renew, repair or replace components due to fair wear and tear.

Faults arising from the use of non-standard or additional parts, or any consequential damage or wear caused by the fitting or use of such parts.

Conquip Engineering Group and/or our recognised agents, directors, employees or insurers will not be held liable for consequential or other damages, losses or expenses in connection with, or by reason of, or the inability to use the product for any purpose.

### **MODIFICATIONS**

If any third party work, modifications or alterations are to be carried out on the product which will involve any welding, drilling or any form of cutting or distortion of materials, full written approval must be obtained from Conquip Engineering Group prior to the work being carried out.

Conquip Engineering Group operate a policy of constant improvement and reserve the right to change specifications without notice.



ITEM NO	PART NUMBER	DESCRIPTION	ADDITIONAL DETAIL
1	ZZ150000	Block Grab Lifting Assembly (CA105AC)	
2	ZZ150083	Block Grab Lifting Assembly Pin	
3	ZZ150001	Block Grab CA105AC Bale Arm	
4	NS800172	Block Grab Bale Arm Bolt	M20 x 220mm Bright Zinc Plated
5	ZZ150002	Block Grab Bale Arm Rubber Stop Block	
6	ZZ150077	Block Grab Top Frame	
7	ZZ150078	Block Grab Top Frame with C-Catch	
8	ZZ150047	Block Grab Locking Catch Inner Assembly	
9	ZZ150012	Block Grab Levelling Arm Assembly	
10	ZZ150060	Arm Height Locator (To Suit 800 Grab)	
11	ZZ15013	Block Grab Level Arm Wheels - Nylon	125mm Diameter, 20mm Bore, 50mm Tread
12	ZZ150021	Block Grab Rubber Gripper	
13	NS800589	Block Grab Level Arm Wheel Bolt	M20 x 100mm Bright Zinc Plated
14	NS800035	Block Grab M20 Nut	M20 Nyloc Bright Zinc Plated
15	ZZ150003	Block Grab Restraint Chain	10mm Galvanised Chain - 600mm Overall Length
16	ZZ150087	Block Grab Restraint Chain Fixing Eye	
17	ZZ150011	8 x 50mm Roll Pin to suit Inner Catch Mechanism	
18	ZZ150010	16 x 60mm Roll Pin to suit Inner Catch Mechanism	
19	ZZ150015	Block Grab Rubber Fixing Block	
20	NS800364	Block Grab H Frame Bolt	M20 x 120mm Bright Zinc Plated
21	NS800369	Block Grab Rubber Fixing Bolt	M8 x 16 Socket Head Cap Screw
22	ZZ150081	Block Grab Heavy Duty Box Catch (CA105AC)	

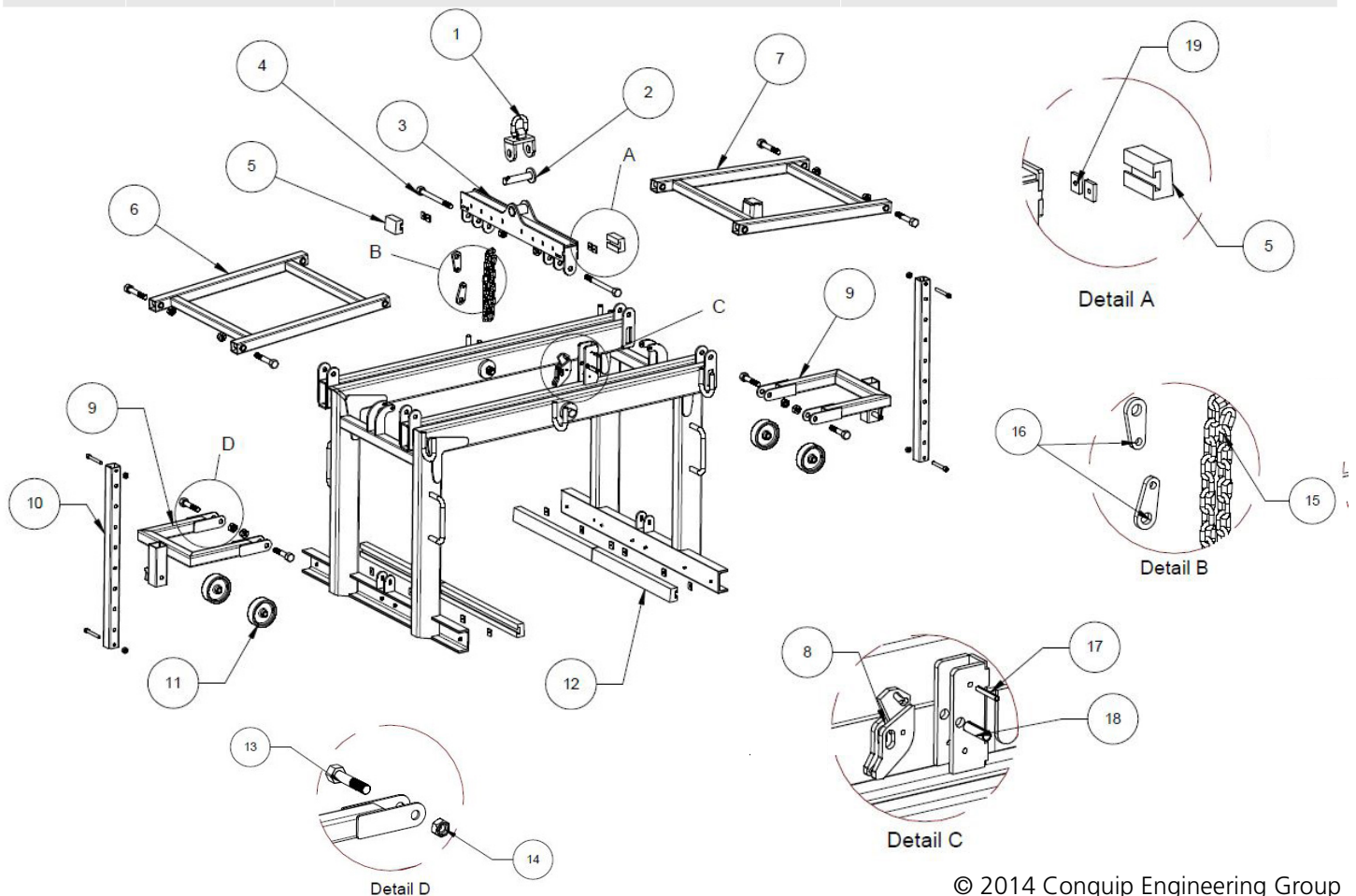

© 2014 Conquip Engineering Group

**TO ORDER CALL 0845 520 1101**

**CONQUIP ENGINEERING GROUP | WATERBROOK ESTATE, ALTON, HANTS, GU34 2UD**